

BPP

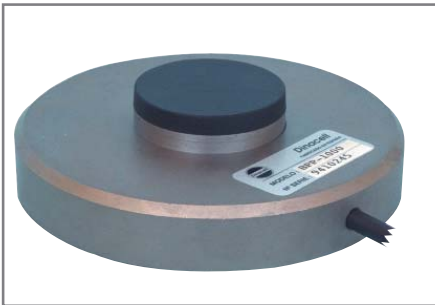

- Load cells specially designed for installation under motor bedframe.
- This cell is manufactured in different capacities from 3.000 kg to 5.000 kg.
- The model BPP and BPP-CB equipped with silent-block pad to avoid the transfer of vibrations.
- Connected to the unit control VK-3, they can installed up to 4 cells in parallel.
- As it is indicated in the diagram of installation , the assembly of 2 cells is recommended to obtain a high precision.

Capacities

3.000 kg
5.000 kg

BPP-CB

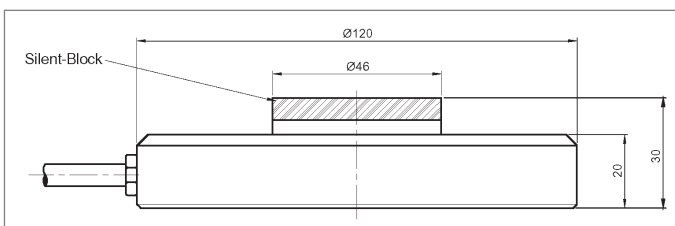
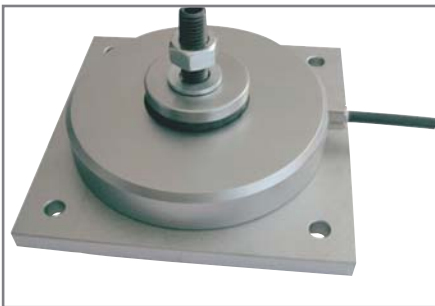

Mod. BPP

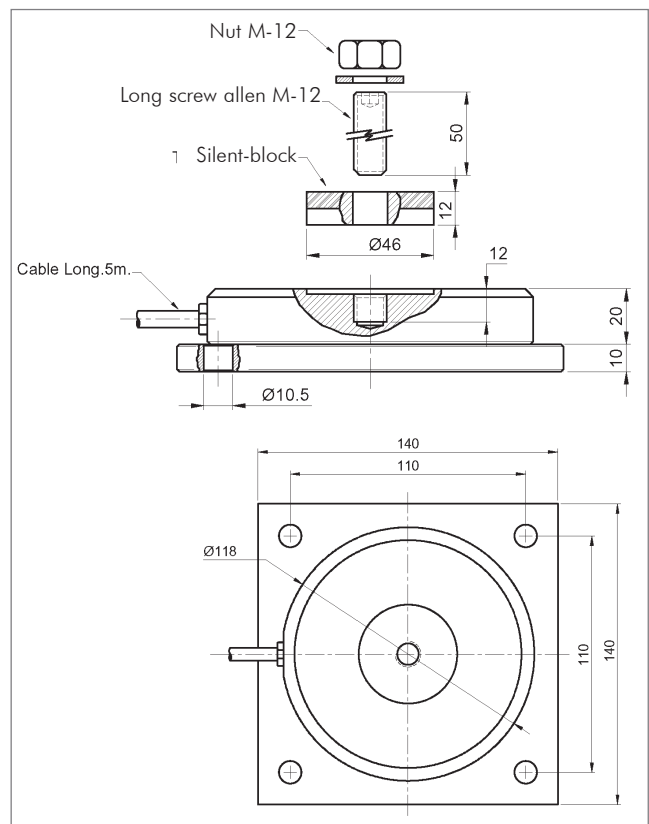

Mod. BPP-CB

CONNECTION

Standard	Excitation +Red
	Excitation -Black
USB	Signal +Green
	Signal -White



Diagram of installation

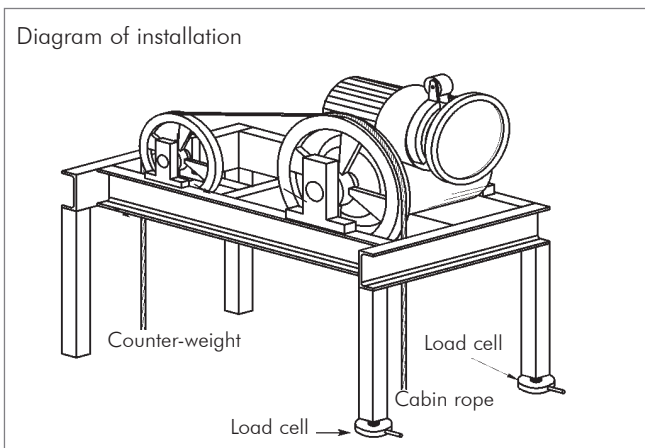

Technical Characteristic

Tension of excitement5..12V
Non linearity	<0.15 % F.S.
Non repeatability	<0.15 % F.S.
Hysteresis	<0.05 % F.S.
Combined error	<0.2 % F.S.
Input resistance350 Ω ± 2
Output resistance350 Ω ± 2
Insulation resistance....(V. Test =100V)	>5.000x10 ⁶ Ω
Maximum work load150 % F.S.
Load limit without lost of characteristic200 % F.S.